

VOCATIONAL SHOP CLASS

The shop area is a building addition to accommodate the relocated shop class. The space will be larger than the existing and include work tables, casework, tool storage, faculty workstation, shoplighting, ample electrical power, and outdoor access for materials delivery. A sloped ceiling will contribute to sound attenuation, while all walls will include sound insulation. Exterior windows for natural light are recommended along the west façade.

GENERAL STORAGE

Four areas of storage are included in the renovation. Three of these with varying depths are located along main circulation corridors. The fourth and largest storage room is located adjacent to the gymnasium to receive both athletic and general storage. All building areas, including storage will contain fire suppression sprinklers as required by Municipal code.

TRAINING AND EXERCISE

This area is to be renovated to allow students, athletes, faculty, and staff the opportunity to promote a healthy lifestyle. The space will include appropriate lighting, floor padding, mirrored walls, electrical power, and sound insulation to house existing and future fitness equipment acquisitions, both cardio and weights.

PERFORMING ARTS CLASSROOM

The building addition includes a dedicated space for education and practice of the performing arts. The space can accommodate 70 seated performers with additional space for instruments, practice, storage, and an office. Paired doors are aligned with existing gymnasium doors to allow convenient transfer of musical instruments and performers. The ceiling will be sloped, walls will be insulated, and sound attenuating materials can be installed as required. This space includes no exterior windows for natural light as requested. Access to the outdoors is provided for travel to events.

CONCESSION AND PANTRY

The concession stand is new construction located along a circulation corridor aside the gymnasium. Cabinetry, a sink, and ample electrical capacity will support the sale of food beverages, and school memorabilia. A large communicating metal shutter will keep the concessions secure. An adjacent pantry is provided for the storage of stock.

LOCKER ROOMS AND RESTROOMS

The new restrooms are accessible from the adjacent circulation corridor. The restrooms include three toilet fixtures and two lavatory sinks. Floors are sloped to drain and exhaust ventilation is provided. Plumbing fixtures can be accessed for maintenance via strategically placed access panels. A communicating door allows the locker room and restroom to function together or independently as required for a specific event. All walls will be insulated and the facility will be compliant with the Americans with Disabilities Act (ADA).

New locker rooms are designed to accommodate athletes within a clean, organized, healthy environment. Large lockers approximately 24"W x 24"D x 42" H are mounted on an elevated concrete base/bench combination. Athletic lockers total 50-60 units supported by four shower stalls and a toilet. Floors are sloped to a drain and exhaust ventilation ensures adequate air exchange. Walls can include painted or adhered graphics to emphasize school/team spirit. The locker rooms are adjacent to and accessible from, a new restroom. The locker rooms will include ADA features.

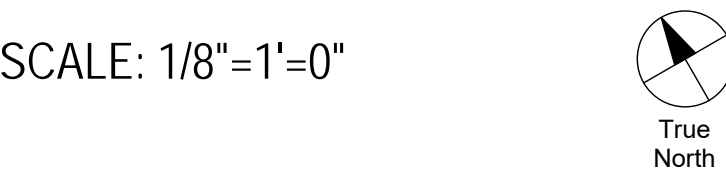
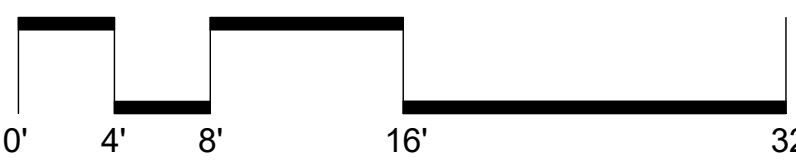
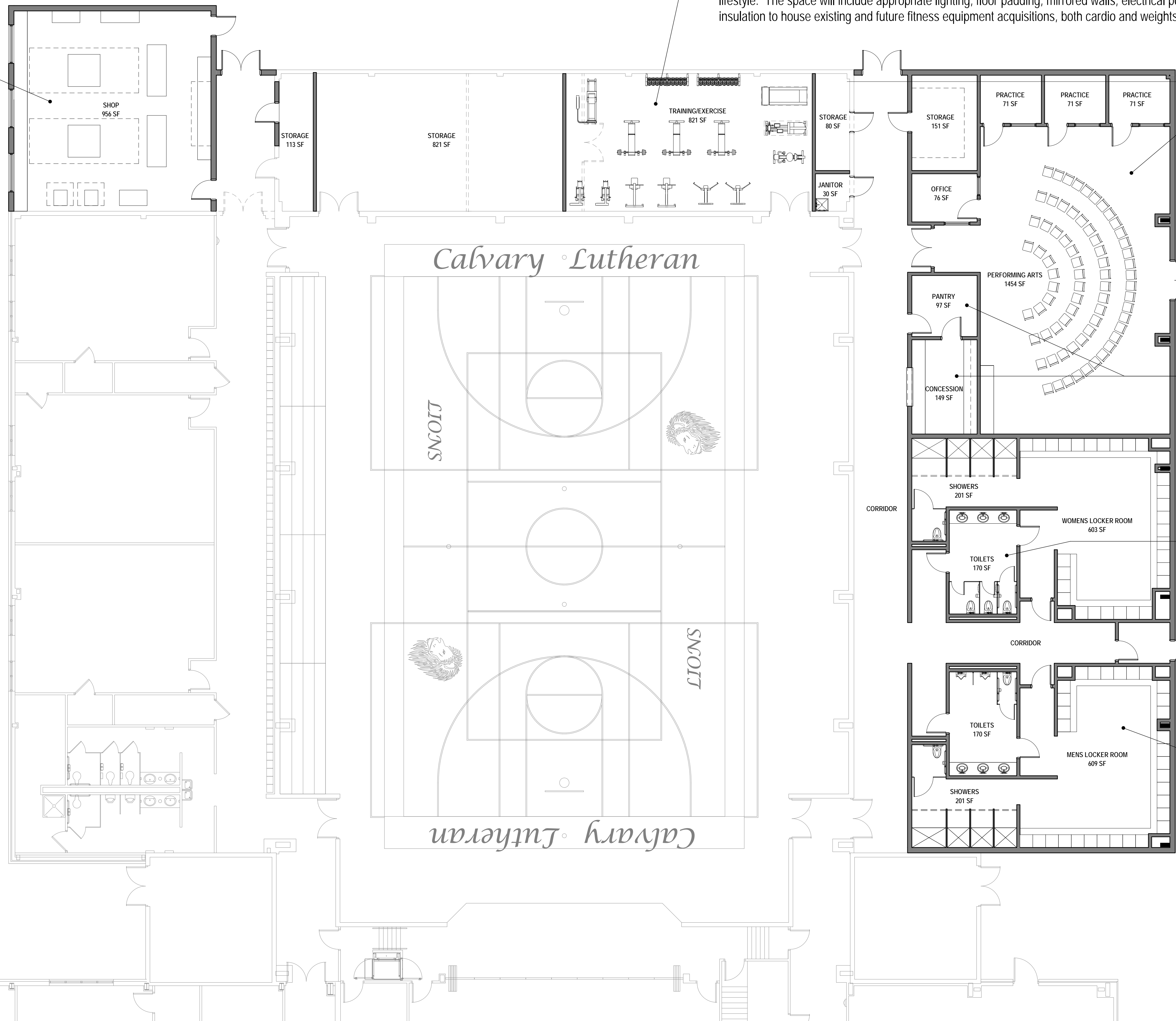

CALVARY LUTHERAN HIGH SCHOOL- PHASE 3

FLOOR PLAN- LEVEL 1

PRELIMINARY DRAFT
DECEMBER 17, 2018

